

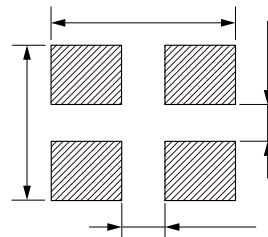

-
-
-
-
-
-

°C

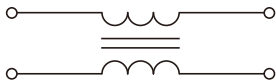
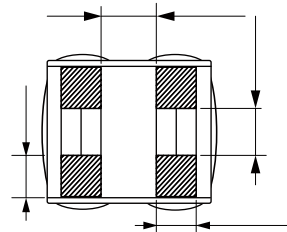
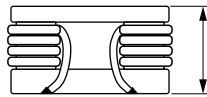
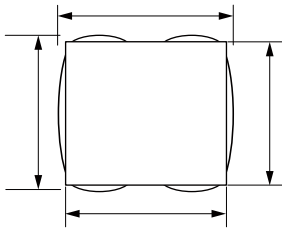

Part No	Impedance @ 100 MHz Min.	Impedance @ 100 MHz Typ.	DC Resistance Max.	Temperature Rise Current Max.
SCM121006-701-90	700	900	12	9.0
SCM121006-801-80	800	1200	20	8.0
SCM121006-102-80	1000	1200	20	8.0
SCM121006-132-40	1200	1400	36	4.0

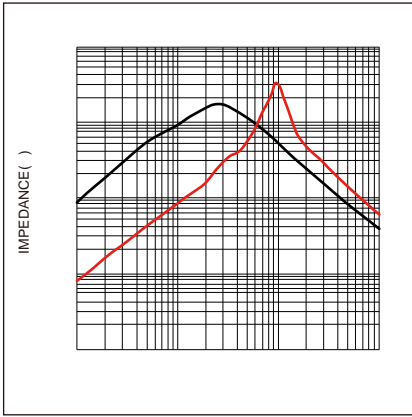
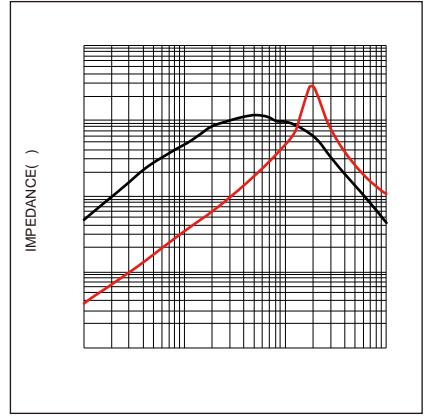
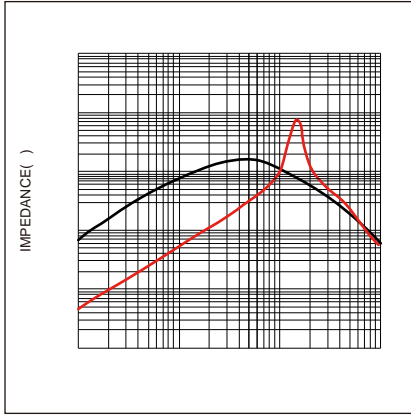
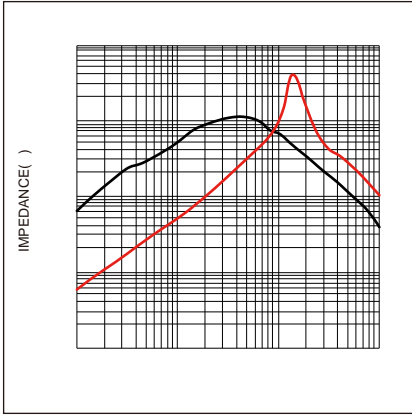

:

•

•

•

•

•

•

•

•

•

•

•

•

•