

MDTA Series

Flat Wire Molded Inductor

Size 6060



FEATURES

- Flat wire coil for low copper losses
- #
- †
- High current capability
- AE# j
- \
- j

APPLICATION

-) #) #
- Noise suppressor for motor
- wipers / power seats/
- Q) ers

Dimensions: [mm]

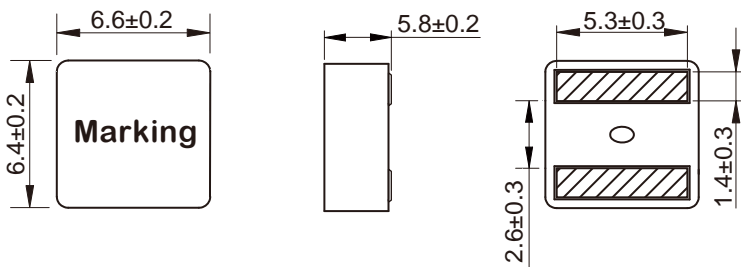

Land Pattern: [mm]

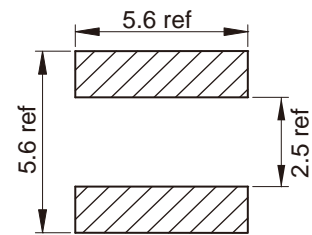

Electrical Properties:

Part No	L@100KHz /0.1V (μH)	Tolerance	I _{SAT} Typ. (A)	I _R (A)		R _{DC} Max. (mΩ)
				20°C rise	40°C rise	
U) u° k U		±20%				
U) u° k U		±20%				
U) u° k U		±20%				
U) u° k U		±20%				
U) u° k U		±20%				
U) u° k U		±20%				
U) u° k U		±20%				
U) u° k U		±20%				
U) u° U		±20%				
U) u° U		±20%				
MDTA6060-220M	22	±20%				

Saturation Current will cause L to drop approximately 30%
 Temperature Rise Current that causes the specified temperature rise from 25°C ambient.

Soldering Reflow:

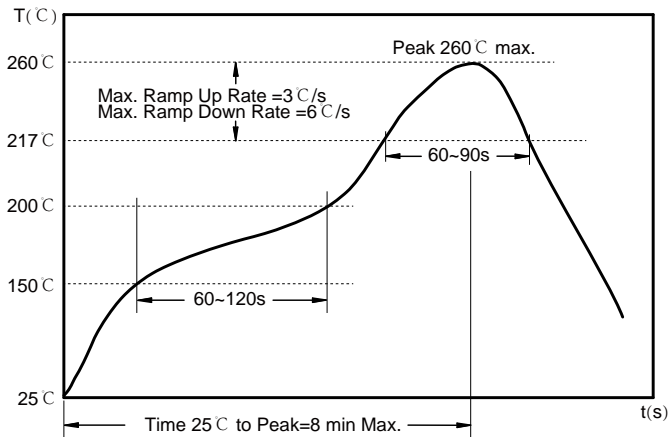

Preheat condition: 150 ~200°C / 60~120 sec.

Allowed time above 217°C : 60~90 sec.

Max temperature: 260°C .

Max time at max temperature: 10 sec.

Allowed Reflow time: 2x max.

Packaging Information:

Tape Dimension :

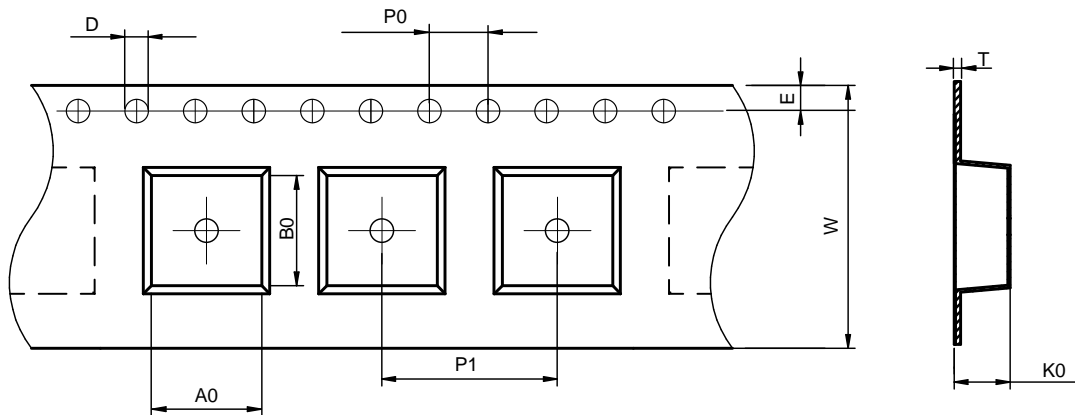

Series	A0 (mm)	B0 (mm)	D (mm)	P0 (mm)	P1 (mm)	W (mm)	K0 (mm)	E (mm)	T (mm)
MDTA6060	7.0± 0.1	6.8± 0.1	1.5± 0.1	4.0± 0.1	12.0± 0.1	16.0± 0.3	6.3± 0.1	1.75± 0.1	0.50± 0.05

Peel force of top cover tape:

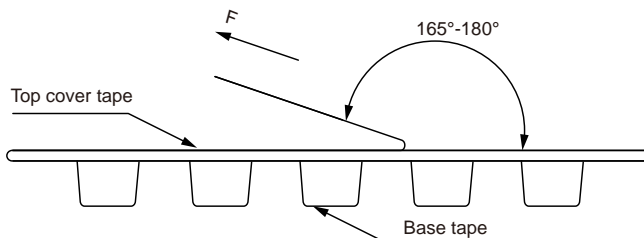

The peel force of top cover tape shall be between 0.1 to 1.3 N

Product Marking:

Marking	Printing Inductance)
---------	----------------------

Reel Dimension: [mm]

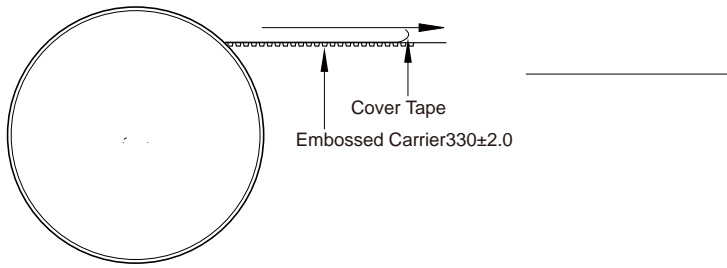

Packaging Quantity: