

MDE Series



FEATURES

- High saturation current realized by material properties and structure design.
- Low DC resistance to achieve high conversion efficiency and lower temperature rising.
- Low Profile.
- Magnetically shielded structure to accomplish high resolution in EMC protection.
- Halogen free, Lead Free, RoHS Compliance.
- Operating temperature: -40 to +125 °C
- Quantity: 3000PCS

APPLICATION

- Generic in portable DC to DC converter line.
- DC/DC converter
- Thin-type power supply module.

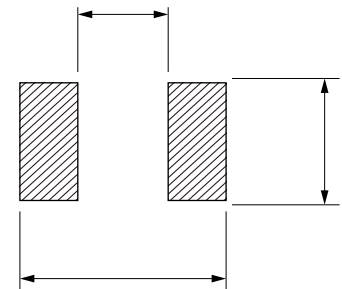
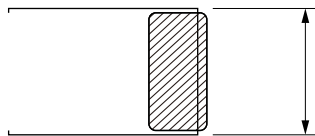
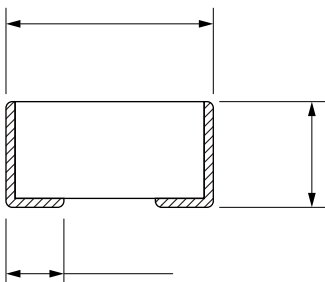

Part No	Inductance @ 1MHz/1V	Tolerance	DC Resistance Typ.	DC Resistance Max.	Current Typ.	Current Max.	Temperature Rise Current Typ.	Temperature Rise Current Max.

Temperature rising current will cause the coil temperature approximate $\pm 40^{\circ}\text{C}$
 Saturation current will cause to drop approximately 30%

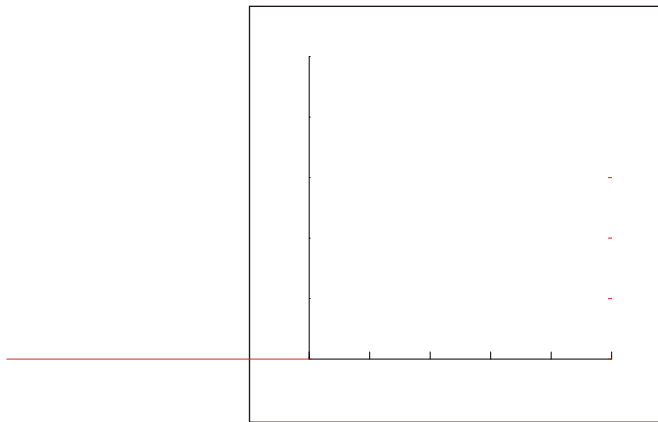
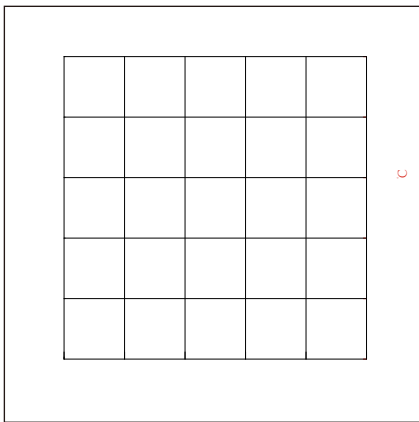
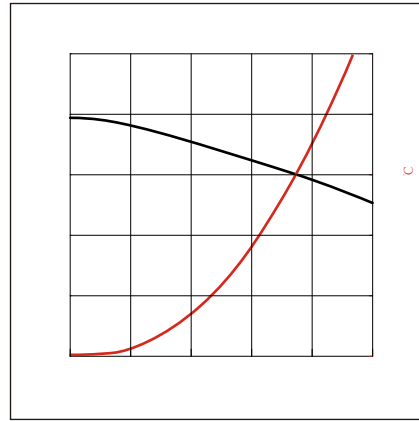
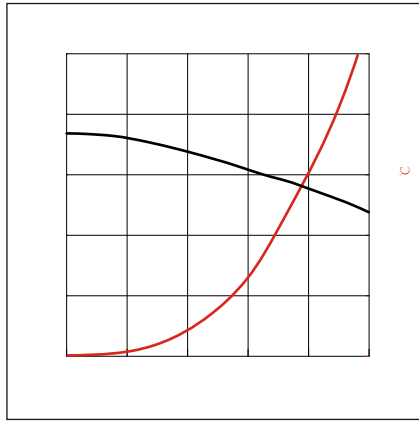
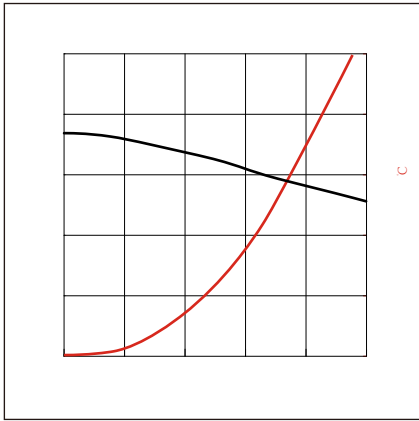

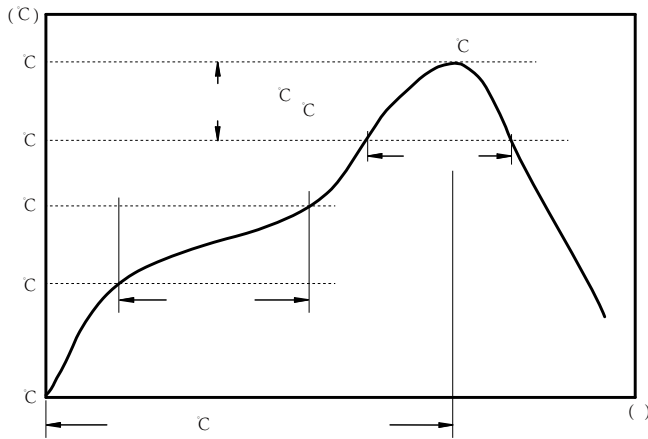

c
c
c
c

:

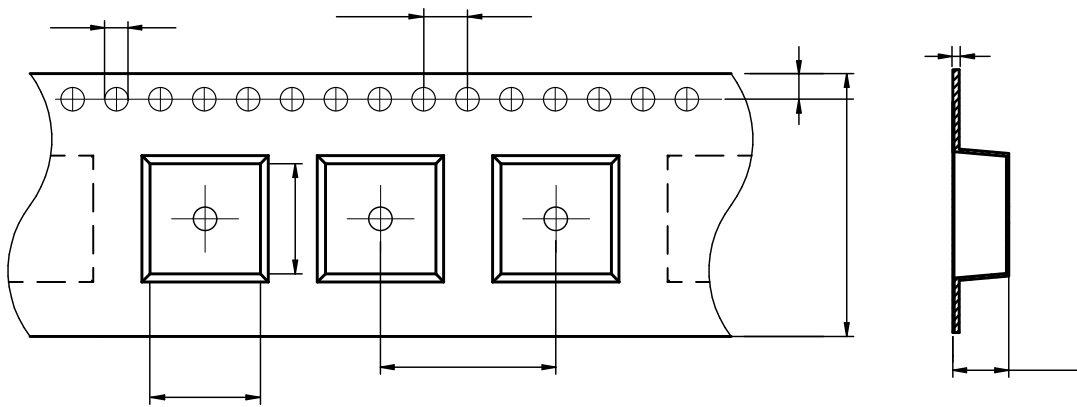

MDE201610	1.82±0.05	2.23±0.05	1.55±0.05	4.0±0.1	4.0±0.1	8.0±0.3	1.15±0.05	1.75±0.1	0.22±0.05

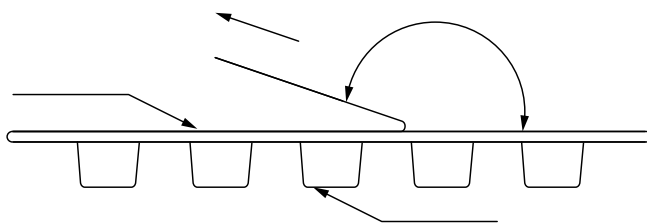

The peel force of top cover tape shall be between 0.1 to 1.3 N

:

