

MDE Series
Molding Power Inductors
Size 1265

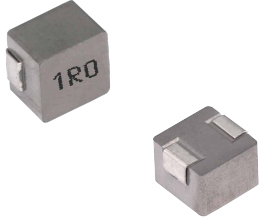

FEATURES

-
-
-
-
-
-
-
-
-
-

°C

APPLICATION

-
-
-
-
-
-
-
-
-
-

Dimensions: [mm]

Land Pattern: [mm]

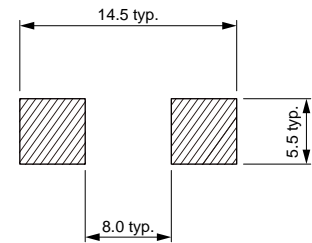
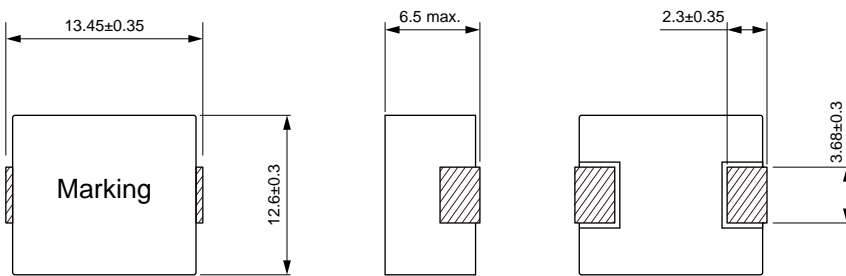

Electrical Properties:

| | | | | | |
|--|--|--|--|-------------------|--|
| | | | | Saturation | |
| | | | | | |

Saturation Current will cause L to drop approximately 30%

Temperature Rise Current: The actual value of DC current when the temperature rise is $\Delta T=40^{\circ}\text{C}$

Typical Electrical Characteristics:

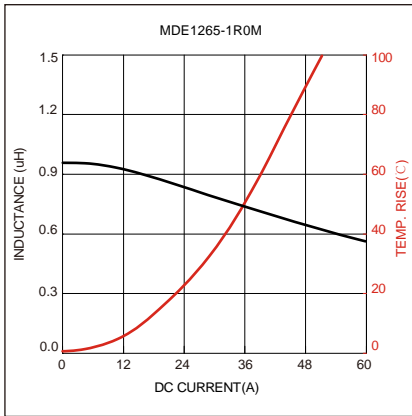

Soldering Reflow:

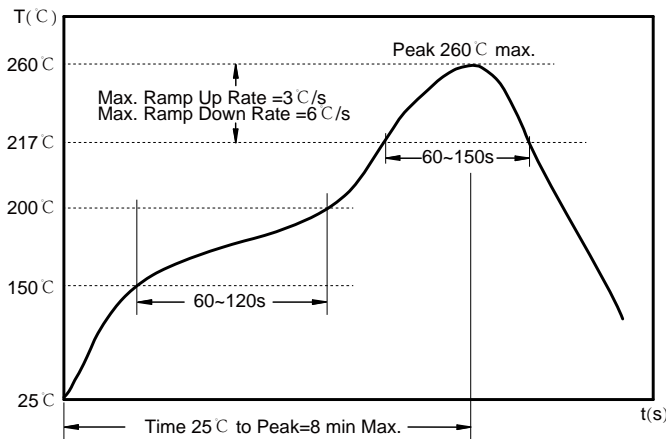

Preheat condition: 150 ~200°C / 60~120 sec.

Allowed time above 217°C : 60~150 sec.

Max temperature: 260°C.

Packaging Information:

Tape Dimension :

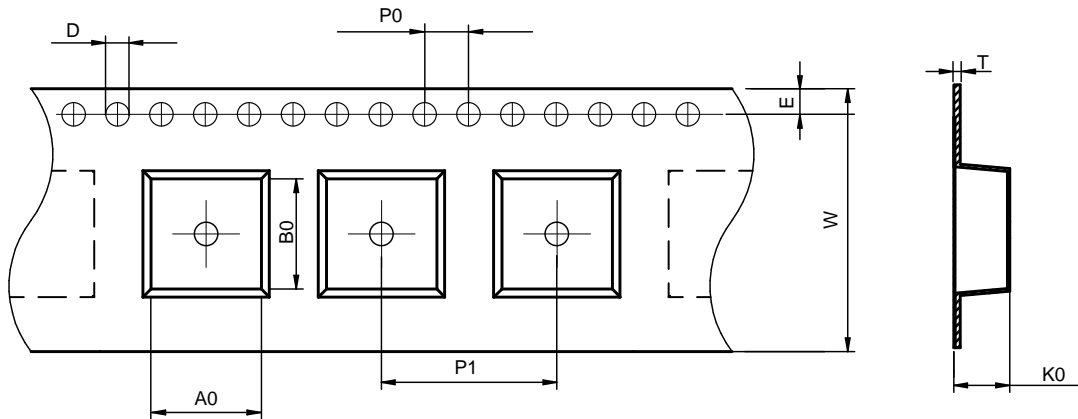

| Series | A0 (mm) | B0 (mm) | D (mm) | P0 (mm) | P1 (mm) | W (mm) | K0 (mm) | E (mm) | T (mm) |
|--------------|----------|----------|---------|---------|---------|--------|---------|----------|-----------|
| MDE1265-1R0M | 13.1±0.1 | 14.0±0.1 | 1.5±0.1 | 4.0±0.1 | 16±0.1 | 24±0.3 | 6.7±0.1 | 1.75±0.1 | 0.50±0.05 |

Peel force of top cover tape:

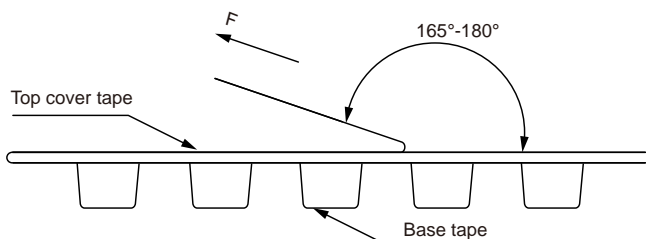

The peel force of top cover tape shall be between 0.1 to 1.3 N

Product Marking:

| Marking | 1R0 |
|---------|-----|
|---------|-----|

Reel Dimension: [mm]

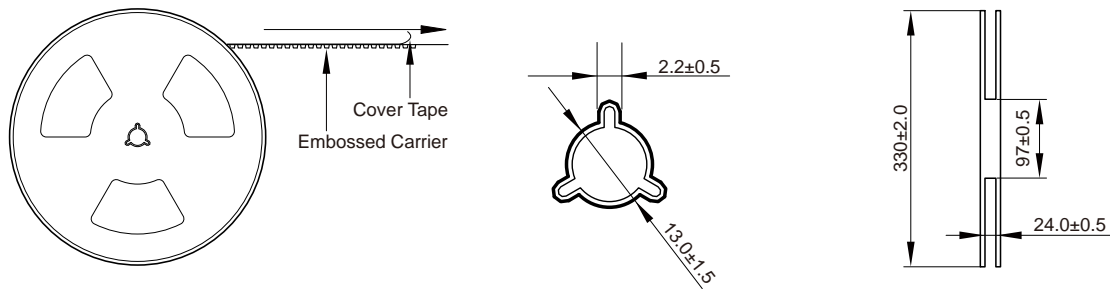

Packaging Quantity:

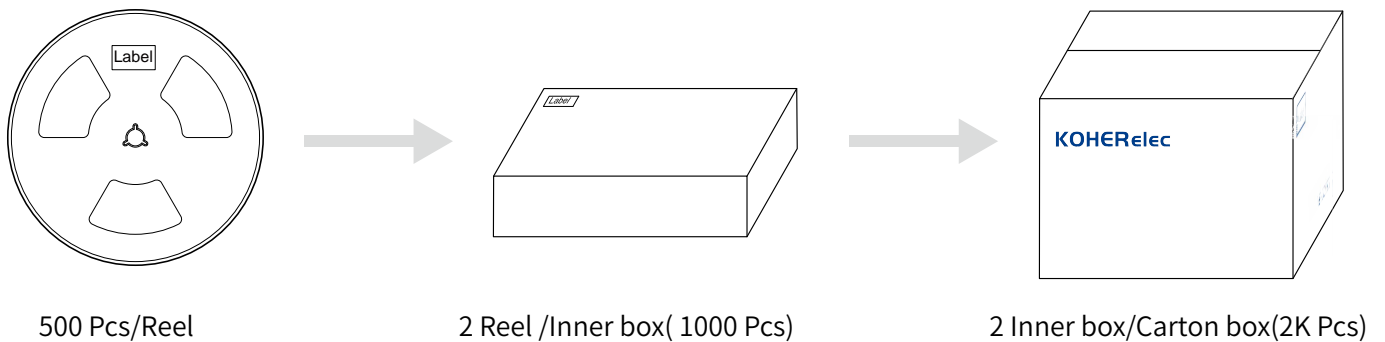

Cautions and Warnings:

Storage Conditions :

- The storage period is within 12 months after the completion of production. Be sure to follow the storage conditions (temperature: -5 to 35°C, humidity: 75% RH Max).If the storage period elapses, the soldering of the terminal electrodes may deteriorate.The warranty period is one year.
- Product should not be exposed to environment with high temperature, high humidity, dust, corrosive gas and etc.
- Products should be handled with care to avoid damage or contamination from perspiration and skin oils.
- Please always handle products carefully to prevent any damage caused by dropping down or inappropriate removing.

Operation Instructions:

- Self heating (temperature increase) occurs when the power is turned ON, so the tolerance should be sufficient for the set thermal design.
- Before soldering, be sure to preheat components.The preheating temperature should be set so that the temperature difference between the solder temperature and chip temperature does not exceed 150°C.
- Soldering corrections after mounting should be within the range of the conditions determined in the specifications.If overheated, a short circuit, performance deterioration, or lifespan shortening may occur.
- Generally, Koher might not be familiar with either customer's specific application or actual requests as customer does.As a result customer shall be responsible for checking and confirming whether Koher product with the performance described in the product specification is suitable for using in customer's particular application or not.