

CMC Series

Common Mode Choke

Size 2517

CHARACTERISTICS

两组相同圈数的线圈绕制在同一磁体上，实现共模噪声的抑制
 采用紧凑均匀的绕线工艺，有效减低寄生电容，提高线间耐压等级
 标称额定电压250Vac; 线间绝缘测试电压1500Vac
 工作温度范围：-55 ~+125

APPLICATION

电源线输入、输出共模噪声消减和浪涌抑制（250Vac）
 电力电源装置的浪涌抑制和EMI滤波
 浮地装置的滤波
 EMI对策用
 特别适用于AC/DC转换，DC/AC逆变等线路的电磁干扰抑制

Dimensions: [mm]

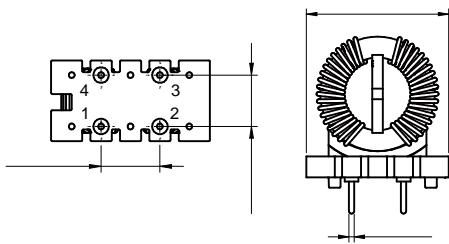

Land Pattern: [mm]

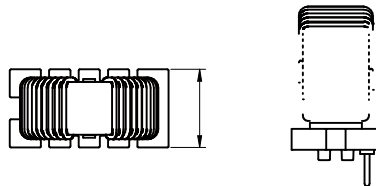

Schematic:

Electrical Properties:

| | | | | | | | |
|--------------|--------|-----|-----|------|-----|--|--|
| CMC2517-102N | 1,000 | 6.0 | 13 | 1500 | 250 | | |
| CMC2517-222N | 2,200 | 4.0 | 30 | 1500 | 250 | | |
| CMC2517-332N | 3,300 | 2.5 | 60 | 1500 | 250 | | |
| CMC2517-502N | 5,000 | 2.5 | 95 | 1500 | 250 | | |
| CMC2517-103N | 10,000 | 2.0 | 125 | 1500 | 250 | | |
| CMC2517-203N | 20,000 | 1.5 | 270 | 1500 | 250 | | |

Typical Electrical Characteristics:

Insertion Loss Common Mode

